

RICHARD T. ERNST, JR.
ARCHITECT
7851 KELLER ROAD
CINCINNATI, OHIO 45243
513-801-7109

CONDITIONAL USE PERMIT FOR:
OUR KIDS PLACE
DAYCARE AT HOLY TRINITY EPISCOPAL CHURCH
7190 EUCLID ROAD CINCINNATI, OHIO 45243

ZONING APP. 6-19-15



1

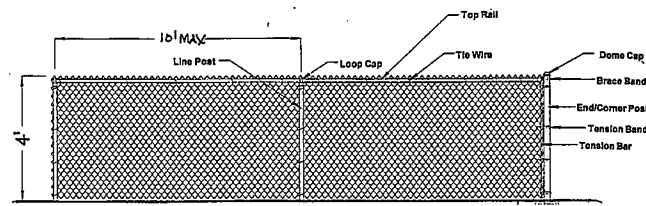
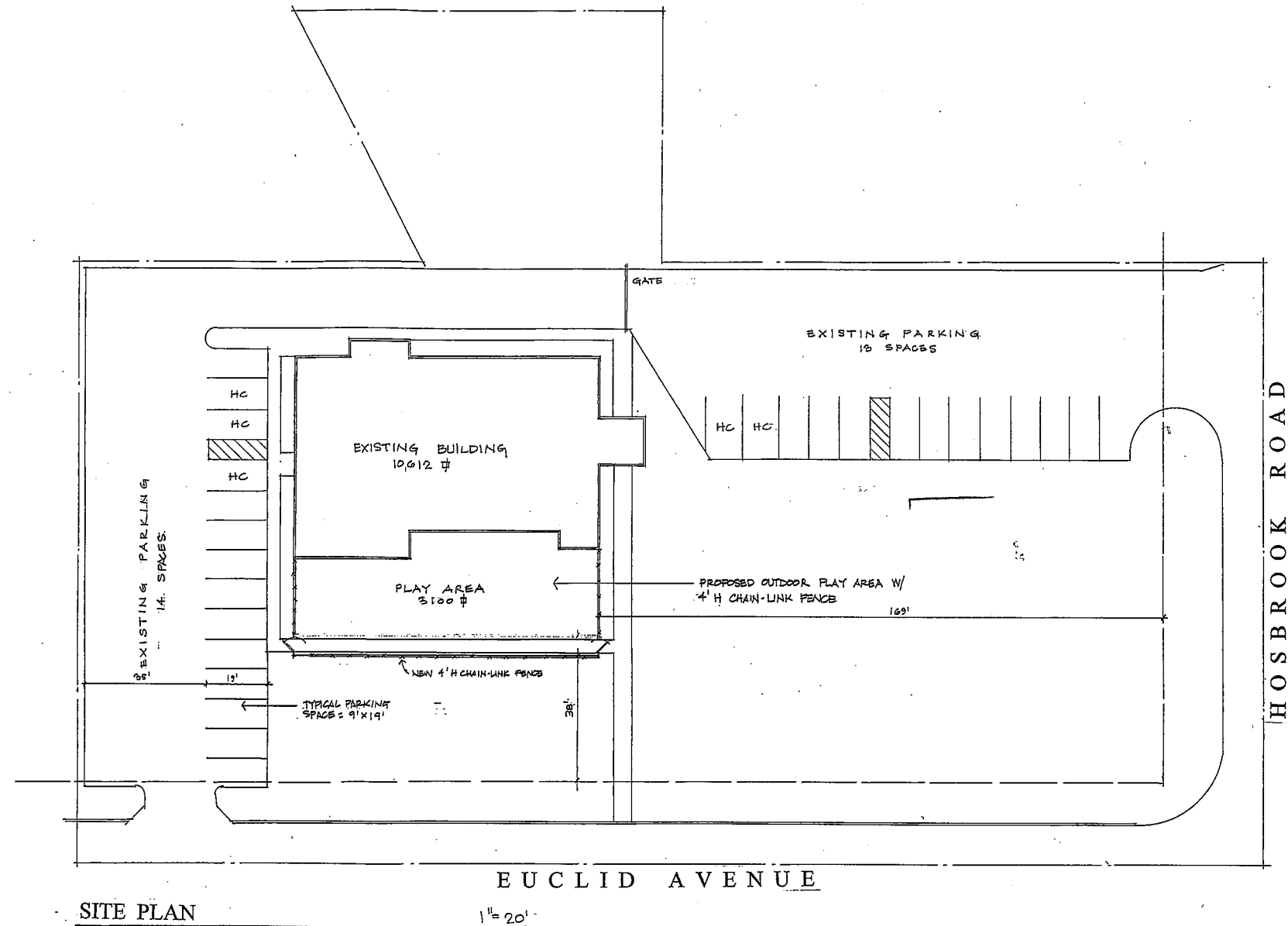

4' CHAIN LINK FENCE ELEVATION

BUILDING CODE ANALYSIS

GOVERNING CODE: CHAPTER 34: EXISTING STRUCTURES 2011 OHIO BUILDING CODE (WITH 2014 REVISIONS)
 USE & OCCUPANCY: EXISTING & PROPOSED: A-3 & E (CHURCH & DAY CARE) MIXED USE, UNSEPARATED
 AREA LIMITATIONS: ALLOWABLE: A-3: 2 STORY/9500 SF W/AREA MODIFICATIONS: A-3: 2STORY/14,500 SF
 E: 2 STORY/14,500 SF E: 2 STORY/21,750 SF
 ACTUAL: 10,612 SF
 CONSTRUCTION TYPE: 2B SOLID MASONRY WALLS, CONCRETE FLOORS
 OCCUPANT LOAD: CHURCH: 100 EDUCATIONAL: 58 (ACTUAL)
 FIRE ALARM SYSTEM: YES SPRINKLER SYSTEM: NO
 EXIT TRAVEL DIST: ALLOWABLE: 200' ACTUAL: 60'
 DESIGN LOADS: 100 PSF OFR FLOORS AND STAIRS
 ZONING: SYCAMORE TOWNSHIP ZONED B RESIDENTIAL DISTRICT CONDITIONAL USE REQUIRED
 PARKING: 28 SPACES PROVIDED CHURCH USE: 25 REQUIRED DAY CARE: 14 REQUIRED

NOTE: THIS PERMIT APPLICATION IS FOR A CONDITIONAL USE PERMIT TO AN EXISTING STRUCTURE. NO STRUCTURAL OR SIGNIFICANT INTERIOR MODIFICATIONS ARE BEING MADE TO THE EXISTING STRUCTURE. THE FIRST FLOOR ASSEMBLY SPACE (CHURCH) WILL REMAIN AS IS WITH NO ALTERATIONS OR WORK PERFORMED. THE LOWER LEVEL WILL CONTINUE TO BE USED AS A DAYCARE, NECESSITATING THE CONDITIONAL USE PERMIT. THIS SPACE WILL REMAIN UNALTERED WITH THE EXCEPTION OF THE ADDITION OF THE FENCED ENCLOSED OUTDOOR PLAY AREA.

SYCAMORE TOWNSHIP
PLANNING & ZONING
JUN 19 2015
RECEIVED

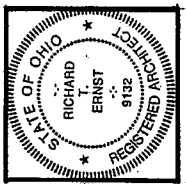

RICHARD T. BERNST, JR.
ARCHITECT
7051 KYLE RD.
CINCINNATI, OHIO 45243
513-801-7102

CONDITIONAL USE PERMIT FOR:
OUR KIDS PLACE
DAYCARE AT HOLY TRINITY EPISCOPAL CHURCH
7190 EUCLID ROAD CINCINNATI, OHIO 45243

ZONING APP. 6/17/15

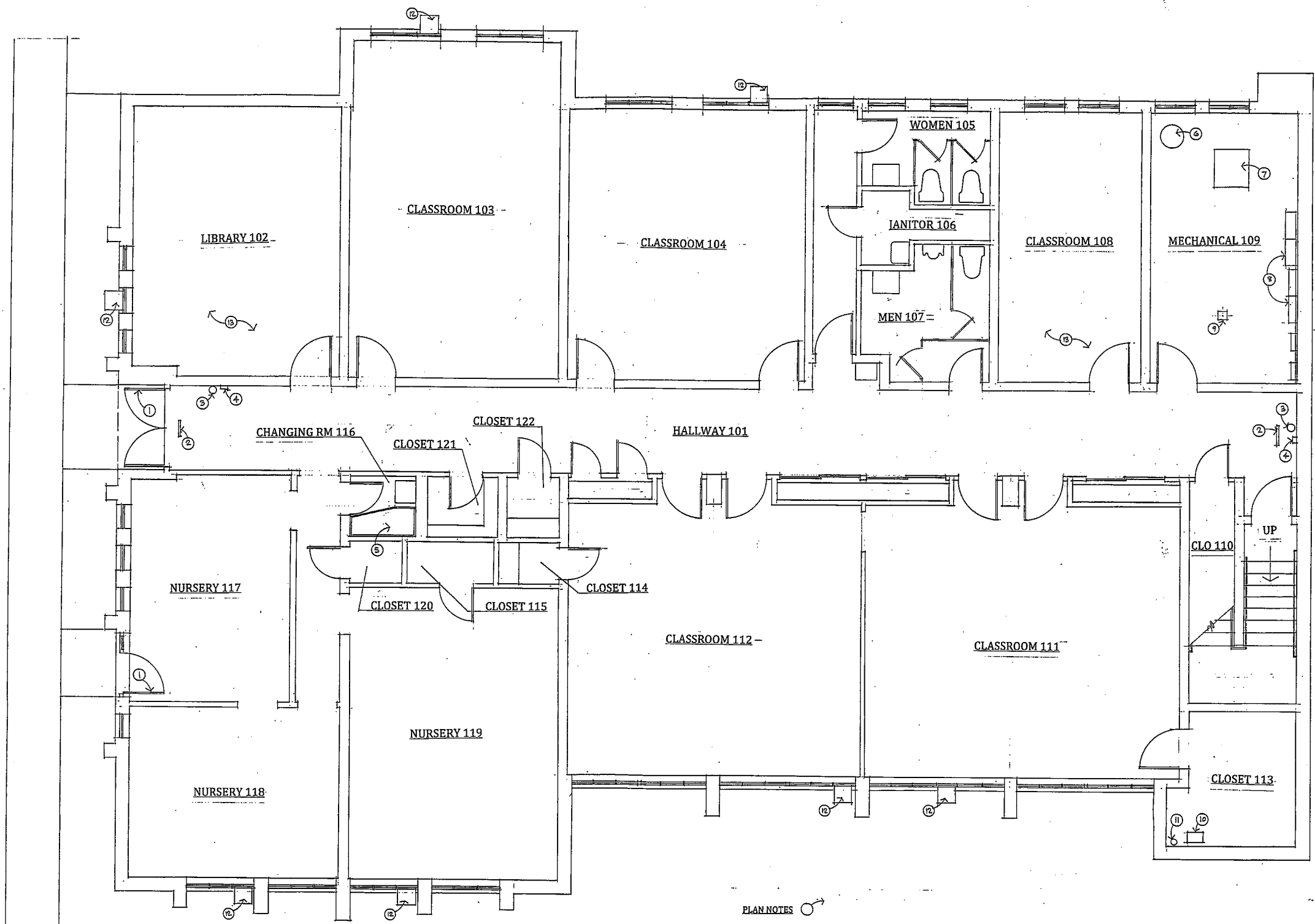
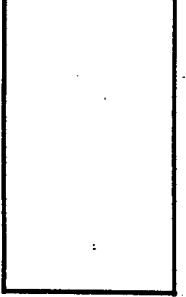

LOWER LEVEL PLAN

1/4" = 1'-0"

PLAN NOTES

1. Install new aluminum framed, insulated tempered-glass door with panic hardware in existing opening.
2. Existing internally lit Exit signage.
3. Existing Fire Extinguisher.
4. Existing Fire Alarm pull-station.
5. Install Baby-changing Station at 36" AFF.
6. Existing Water Heater.
7. Existing Boiler.
8. Existing Electric Panels.
9. Existing Floor Drain.
10. Existing Gas Meter.
11. Existing Water Line.
12. Existing window unit Air conditioner.
13. This room for church use only.