

© COPYRIGHT 2015 CADSTRUCT, INC. PRINT TO SCALE (22X34) - HALF SCALE FOR (11X17)

GENERAL NOTES:

- ALL ITEMS ARE EXISTING TO REMAIN
- ALL ELECTRIC TO REMAIN THE SAME. ANY MODIFICATIONS OR ADJUSTMENTS TO THE ELECTRICAL SHALL BE PERFORMED BY A PROFESSIONALLY LICENSED ELECTRICIAN AND BROUGHT TO CODE ACCORDINGLY
- ALL PLUMBING TO BE PERFORMED BY A PROFESSIONALLY LICENSED PLUMBER

DRAWINGS NOTES:

- EXISTING HARDWOOD FLOORS - 312 BAR
- EXISTING CARPETED FLOORS TO BE REMOVED AND REPLACED WITH HARDWOOD - BARBER SHOP
- EXISTING TILE FLOORS - 312 BAR
- EXISTING TILE FLOORS TO BE REMOVED AND REPLACED WITH HARDWOOD - BARBER SHOP
- EXISTING HVAC - 312 BAR/ BARBER SHOP
- EXISTING INTERIOR DOOR TO BE REMOVED AND REPLACED WITH NEW VENTED DOOR
- EXISTING EXTERIOR DOOR - 312 BAR
- EXISTING EXTERIOR DOOR TO BE REMOVED AND REPLACED WITH NEW EXTERIOR DOOR AND PUSH BAR FOR EXIT - BARBER SHOP
- EXISTING WINDOWS - 312 BAR
- EXISTING WINDOWS - BARBER SHOP
- EXISTING WINDOWS TO BE REMOVED AND REPLACED WITH GLASS BLOCK OR SIMILAR TO EXISTING WINDOW
- EXISTING WOOD STUD AND PLASTER PARTITION
- EXISTING WOOD STUD AND PLASTER PARTITION TO BE REMOVED. MASONRY PARTITION WITH PLASTER TO BE SKIM COATED WITH PLASTER TO MEET MINIMUM FIRE RATED SEPERATION
- EXISTING MASONRY AND PLASTER PARTITION
- EXISTING MASONRY AND PLASTER PARTITION TO BE REMOVED AND REINFORCED HEADER TO BE INSTALLED PRIOR TO MASONRY REMOVAL
- EXISTING COUNTERTOP AND BAR EQUIPMENT
- EXISTING WALK IN FREEZER
- EXISTING COUNTERTOP AND WASH STATION
- EXISTING COOKING EQUIPMENT WITH VENTILATION SYSTEM - UNUSED
- LINE INDICATES STRUCTURAL BEAM IN CEILING ABOVE
- EXISTING CONCRETE STAIRS

- EXISTING WOOD DECK
- EXISTING RAILING
- EXISTING WOOD STAIRS
- EXISTING WOOD STAIRS TO BASEMENT
- EXISTING WOOD STAIRS TO SECOND FLOOR APT.
- EXISTING WATER CLOSET TO BE REMOVED AND REPLACED WITH NEW H.E. WATER CLOSET

WALL TYPES (EXIST):

- A. EXISTING EXTERIOR WALL, FACE BRICK EXTERIOR, FACE PLASTER INTERIOR, 8" CMU REINF. HORIZ. @16" O.C., FACE PLASTER INTERIOR
- B. EXISTING EXTERIOR WALL, FACE BRICK EXTERIOR, 8" CMU REINF. HORIZ. @16" O.C., FACE PLASTER INTERIOR, 2x4 STUD WALL W- 5/8" DRYWALL FACE
- C. EXISTING EXTERIOR WALL, 8" CMU REINF. HORIZ. @16" O.C., FACE PLASTER BOTH SIDES
- D. EXISTING INTERIOR WALL, 2x4 CONSTRUCTION, FACE BOTH SIDES W- 5/8" DRYWALL
- E. EXISTING INTERIOR WALL, 8" CMU REINF. HORIZ. @16" O.C. FACE BOTH SIDES PLASTER.

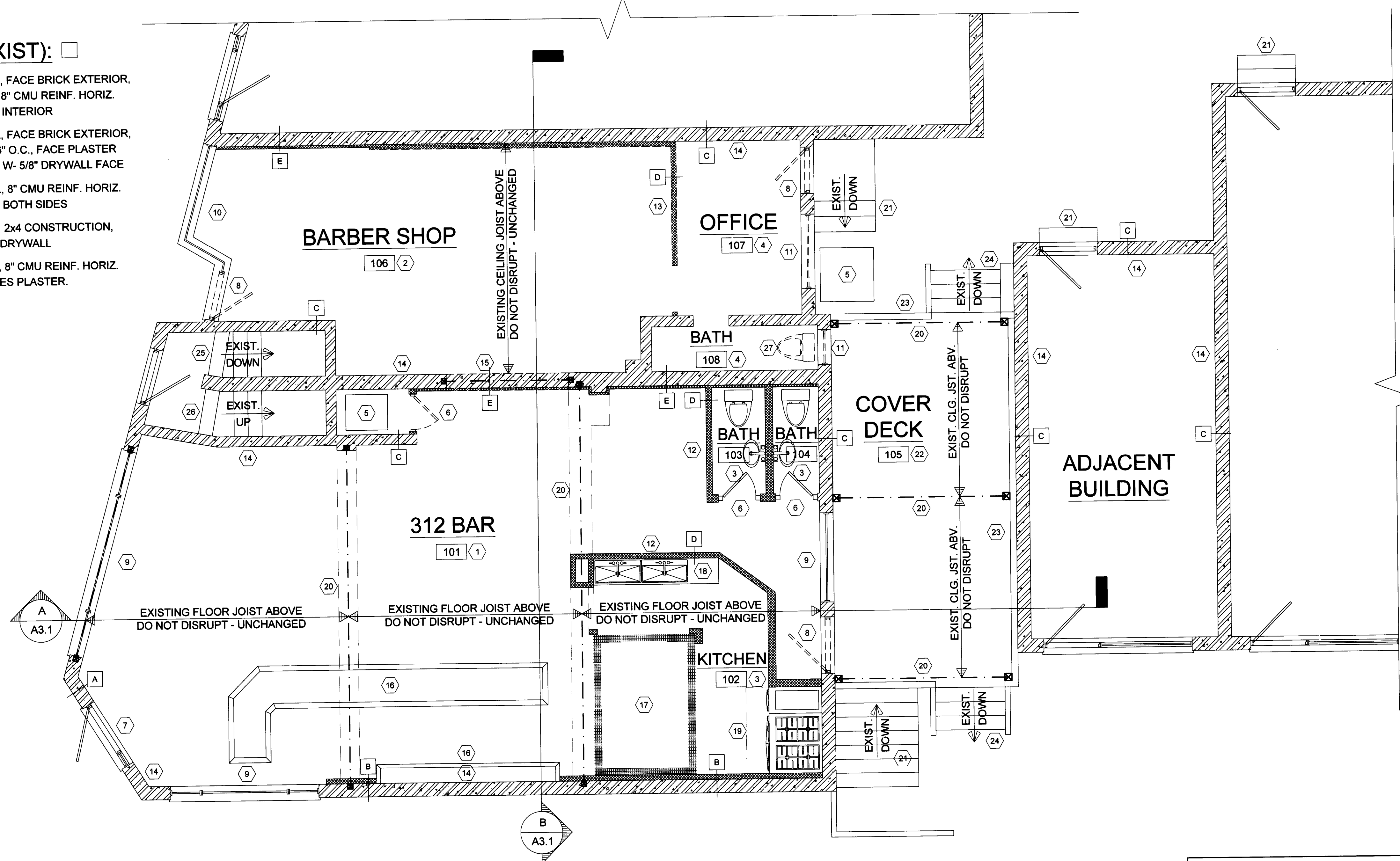

DEMOLITION FLOOR PLAN

SCALE: 1/4" = 1'-0"

| DESCRIPTION | DATE | J.L.S. |
|---|----------|--------------|
| PRODUCTION OF PRELIMINARY CONST. DWGS FOR JOHN R. GRIER, AIA REVIEW | 04/28/15 | PRELIMINARY |
| PRODUCTION OF FINAL CONST. DWGS FOR JOHN R. GRIER, AIA APPROVAL | 05/08/15 | CONSTRUCTION |
| REVISED PAGE C1.1 TO INCLUDE DIMENSIONS ON PARKING SPACES | 07/21/15 | CONSTRUCTION |

DRAWN BY: J.L.S.
 ISSUED: PRELIMINARY
 REV #1: CONSTRUCTION
 REV #2: CONSTRUCTION
 REV #3: DEMO/REMODEL

8450 BLUE ASH, LLC.
 312 (TENANT)
 8450 BLUE ASH ROAD
 SYCAMORE TWP., OH 45236

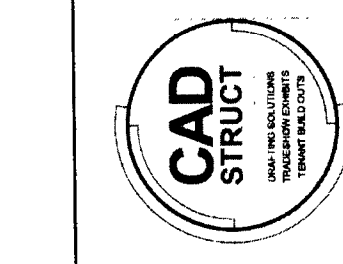

JOHN R. GRIER ARCHITECT
 11309 DEERFIELD ROAD, CINCINNATI, OHIO 45242
 Phone (513) 489-3690 Fax (513) 489-3699
 e-mail: jgrier@fuse.net

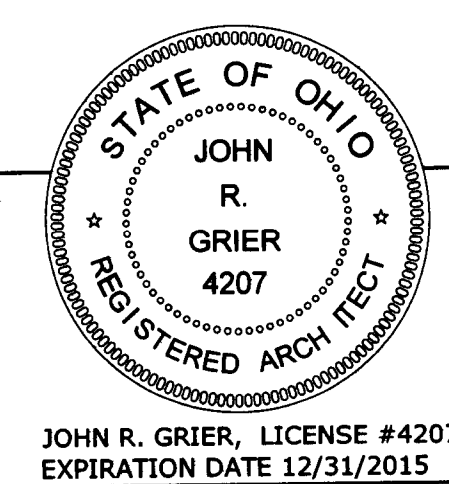

SHEET #:
D1.2
 DEMOLITION PLAN