

© COPYRIGHT 2015 CADSTRUCT, INC. PRINT TO SCALE (22X34) - HALF SCALE FOR (11X17)

**GENERAL NOTES:**

1. ALL ITEMS ARE EXISTING TO REMAIN
2. ALL ELECTRIC TO REMAIN THE SAME. ANY MODIFICATIONS OR ADJUSTMENTS TO THE ELECTRICAL SHALL BE PERFORMED BY A PROFESSIONALLY LICENSED ELECTRICIAN AND BROUGHT TO CODE ACCORDINGLY
3. ALL PLUMBING TO BE PERFORMED BY A PROFESSIONALLY LICENSED PLUMBER

**DRAWINGS NOTES:**

- |   |   |   |
|---|---|---|
| <ol style="list-style-type: none"> <li>1. EXISTING HARDWOOD FLOORS - 312 BAR</li> <li>2. EXISTING CARPETED FLOORS - BARBER SHOP</li> <li>3. EXISTING TILE FLOORS - 312 BAR</li> <li>4. EXISTING TILE FLOORS - BARBER SHOP</li> <li>5. EXISTING HVAC - 312 BAR/ BARBER SHOP</li> <li>6. EXISTING INTERIOR DOOR</li> <li>7. EXISTING EXTERIOR DOOR - 312 BAR</li> <li>8. EXISTING EXTERIOR DOOR - BARBER SHOP</li> <li>9. EXISTING WINDOWS - 312 BAR</li> </ol> | <ol style="list-style-type: none"> <li>10. EXISTING WINDOWS - BARBER SHOP</li> <li>11. EXISTING WOOD STUD AND PLASTER PARTITION</li> <li>12. EXISTING MASONRY AND PLASTER PARTITION</li> <li>13. EXISTING COUNTERTOP AND BAR EQUIPMENT</li> <li>14. EXISTING WALK IN FREEZER</li> <li>15. EXISTING COUNTERTOP AND WASH STATION</li> <li>16. EXISTING COOKING EQUIPMENT WITH VENTILATION SYSTEM - UNUSED</li> <li>17. LINE INDICATES STRUCTURAL BEAM IN CEILING ABOVE</li> <li>18. EXISTING CONCRETE STAIRS</li> </ol> | <ol style="list-style-type: none"> <li>19. EXISTING WOOD DECK</li> <li>20. EXISTING RAILING</li> <li>21. EXISTING WOOD STAIRS</li> <li>22. EXISTING WOOD STAIRS TO BASEMENT</li> <li>23. EXISTING WOOD STAIRS TO SECOND FLOOR APT.</li> </ol> |
|---|---|---|

**WALL TYPES (EXIST):**

- A. EXISTING EXTERIOR WALL, FACE BRICK EXTERIOR, FACE PLASTER INTERIOR, 8" CMU REINF. HORIZ. @16" O.C., FACE PLASTER INTERIOR
- B. EXISTING EXTERIOR WALL, FACE BRICK EXTERIOR, 8" CMU REINF. HORIZ. @16" O.C., FACE PLASTER INTERIOR, 2x4 STUD WALL W- 5/8" DRYWALL FACE
- C. EXISTING EXTERIOR WALL, 8" CMU REINF. HORIZ. @16" O.C., FACE PLASTER BOTH SIDES
- D. EXISTING INTERIOR WALL, 2x4 CONSTRUCTION, FACE BOTH SIDES W- 5/8" DRYWALL
- E. EXISTING INTERIOR WALL, 8" CMU REINF. HORIZ. @16" O.C., FACE BOTH SIDES PLASTER.

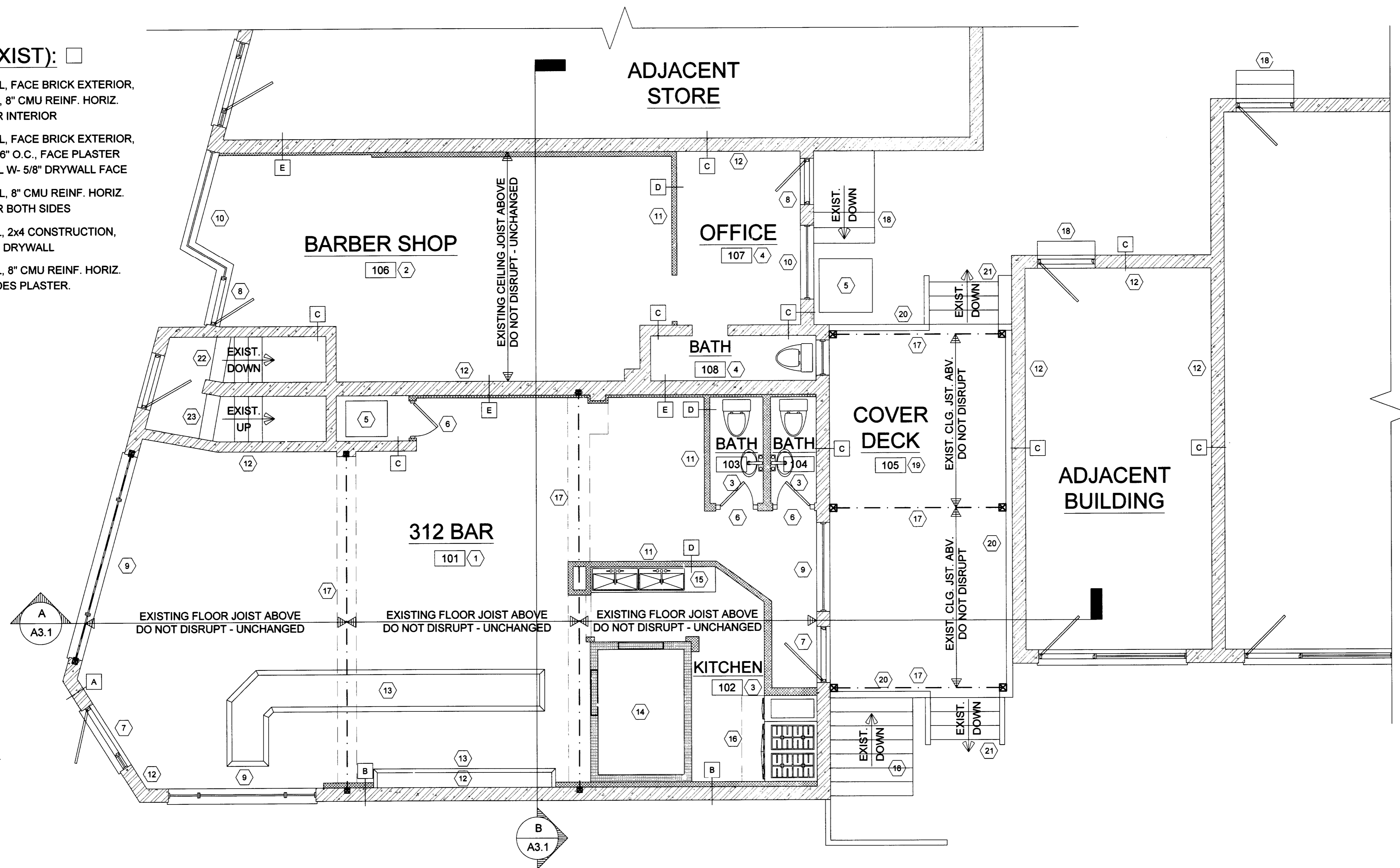

**EXISTING FLOOR PLAN**

SCALE: 1/4" = 1'-0"

**JOHN R. GRIER**  
 ARCHITECT  
 11309 DEERFIELD ROAD, CINCINNATI, OHIO 45242  
 Phone (513) 489-3690 Fax (513) 489-3699  
 e-mail: jgrier@tuse.net

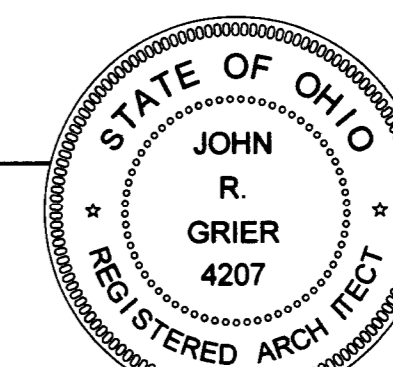

SHEET #:  
**D1.1**  
 EXIST. FIRST FLOOR PLAN

8450 BLUE ASH, I.L.C. 312 (TENANT) 8450 BLUE ASH ROAD SYCAMORE TWP., OH 45236 DEMO/REMODEL	DESCRIPTION: PRODUCTION OF PRELIMINARY CONST. DWGS FOR JOHN R. GRIER, AIA REVIEW PRODUCTION OF FINAL CONST. DWGS FOR JOHN R. GRIER, AIA APPROVAL REVISED PAGE C1.1 TO INCLUDE DIMENSIONS ON PARKING SPACES
DATE: 04/28/15 05/06/15 07/21/15	ISSUED: PRELIMINARY CONSTRUCTION CONSTRUCTION
REV #1: REV #2: REV #3:	REV #1: REV #2: REV #3:
J.L.S. J.L.S. J.L.S.	J.L.S. J.L.S. J.L.S.

**CAD**  
 IN C O R  
 P O B O X  
 C I N C I N N A T I  
 ( 5 1 3 ) 4 0 0

