

**ARCHBISHOP MOELLER HIGH SCHOOL**  
OUTDOOR ATHLETIC FACILITY IMPROVEMENTS  
9001 Montgomery Road  
Cincinnati, Ohio 45242

This drawing and the design concepts represented herein are the property of MSA Sport, Inc. and shall remain the property of MSA Sport, Inc. and shall not be used, copied, or reproduced in any form without the written consent of MSA Sport, Inc.

DATE	ISSUED
10-28-2012	ZONING PERMIT

NO.	DATE	REVISION

PROJECT NO. 12106.00  
DRAWING TITLE  
ZONING SITE PLAN,  
SITE SECTION &  
GENERAL NOTES

**71.0**

**GENERAL NOTES**

1. ALL SPEAKERS SHALL PROVIDE A MAXIMUM OF 55 DBs WHEN MEASURED AT THE PROPERTY LINES.
2. ALL FINAL SPEAKER SETTINGS ARE TO BE PER MANUFACTURERS RECOMMENDATIONS AND TO BE WITHIN COUNTY REGULATIONS FOR AMPLIFICATION.
3. REFER TO SPEAKER CUT SHEETS FOR ADDITIONAL TECHNICAL INFORMATION.
4. NEW SPEAKERS TO BE INSTALLED CLOSE TO ADJACENT PROPERTY LINES HAVE BEEN DIMENSIONED FROM THE CENTERLINE OF THE SPEAKER TO THE CLOSEST PROPERTY LINE.

**KEY NOTES**

1. NEW SPEAKER LOCATION, HALL-MOUNTED TO THE EXISTING PRESS BOX. SPEAKERS ARE TO BE AIMED TOWARD EXISTING ADJACENT BLEACHERS.
2. NEW SPEAKER LOCATION HALL-MOUNTED TO THE EXISTING O'CONNOR CENTER. SPEAKERS ARE TO BE AIMED TOWARD EXISTING ADJACENT EXTERIOR VIEWING PLATFORM.
3. NEW SPEAKER ATTACHED TO NEW 12' HIGH POLE. NEW POLES TO BE INSTALLED PER MANUFACTURERS RECOMMENDATIONS. SPEAKERS ARE TO BE AIMED TOWARD EXISTING ADJACENT BLEACHERS.
4. NEW SCREEN PLANTING LOCATED BEHIND EXISTING SOCCER BLEACHERS. SPECIES OF PLANTING TO BE DARK GREEN AMERICAN ARBORVITAE. REFER TO LEGEND FOR ADDITION INFORMATION.

PLANTING TO EXTEND 24'-0" PAST THE WEST EDGE OF THE EXISTING BLEACHER PAD AND 6'-0" PAST THE EAST EDGE OF THE EXISTING BLEACHER PAD.

5. NEW BLACK VINYL COATED CHAIN LINK FENCE GATE LOCATION. GATE TO BE 9'-0" WIDE AND MATCH EXISTING FENCE HEIGHT. ALL NEW GATE HARDWARE TO MATCH EXISTING HARDWARE.

**LEGEND**

- ▲ = NEW SPEAKER LOCATION  
QUANTITY: 5
- ⊙ = NEW SCREEN PLANTING LOCATION  
QUANTITY: 22  
SCIENTIFIC NAME: TALIA OCCIDENTALIS 'NIGRA'  
COMMON NAME: DARK GREEN AMERICAN ARBORVITAE  
SIZE / REMARKS: 7'-0" B&B, 4'-8" O.C.

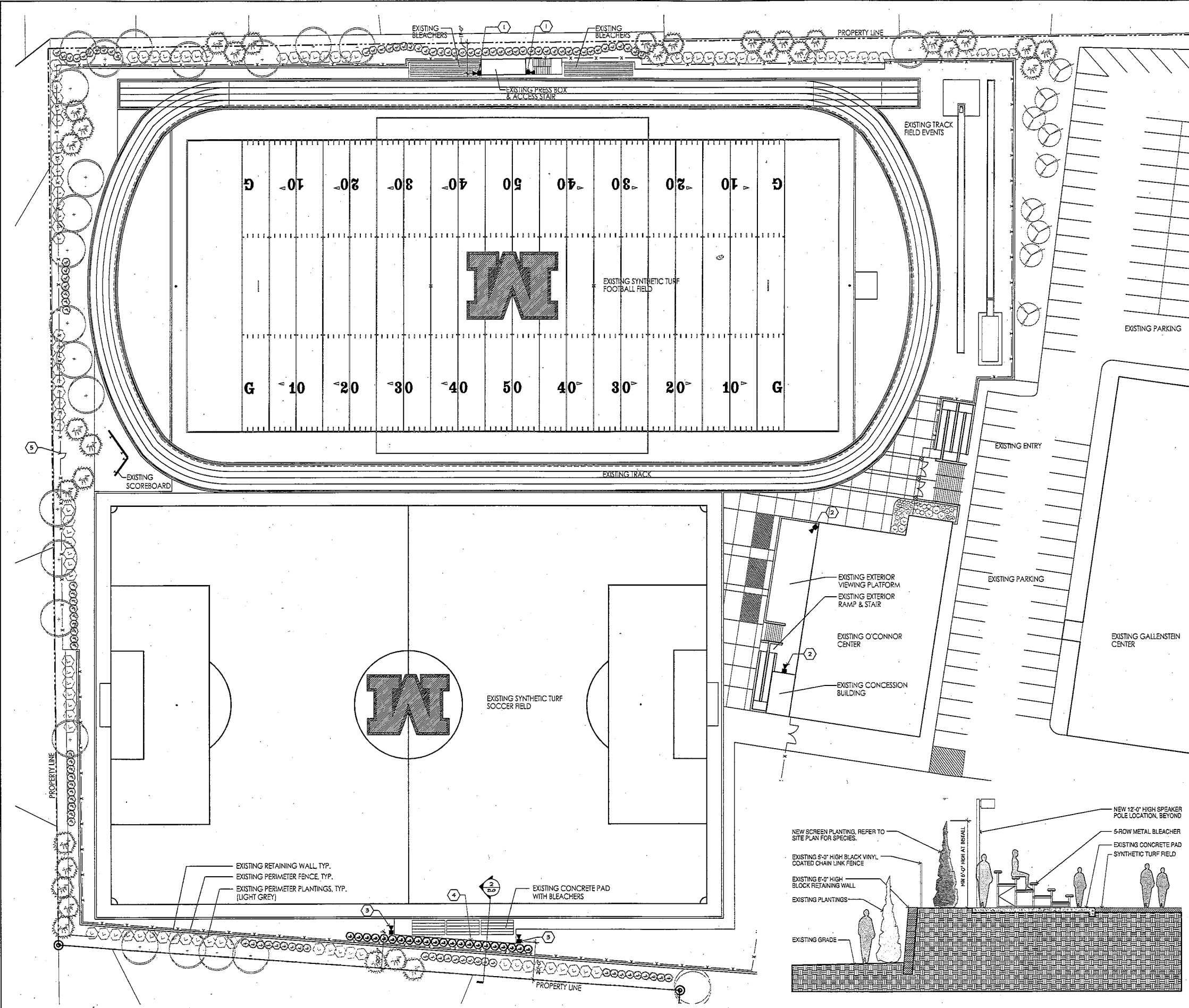

ZONING SITE PLAN  
SCALE: 1" = 20'-0"

ZONING SITE SECTION  
SCALE: 1/4" = 1'-0"

SYCAMORE TOWNSHIP  
PLANNING & ZONING  
OCT 12 2012  
RECEIVED