

TYPICAL INLINE CLEAN OUT DETAIL

UTILITY NOTES

1. CONTRACTORS SHALL FIELD VERIFY THE LOCATION OF ALL EXISTING UTILITIES PRIOR TO BEGINNING CONSTRUCTION.
2. ALL CATCH BASINS LOCATED IN PAVEMENT SHALL HAVE H-20 TRAFFIC BEARING GRATES.
3. GENERAL CONTRACTOR SHALL INSTALL WORK ON THE SITE AND IN THE RIGHT OF WAY PER THE LOCAL CODES & REGULATIONS.
4. ITEM NUMBERS REFER TO THE RECENT EDITION OF THE OHIO DEPARTMENT OF TRANSPORTATION CONSTRUCTION AND MATERIAL SPECIFICATIONS.
5. BUILDINGS MUST BE UNDER ROOF PRIOR TO CONNECTION TO SANITARY LATERAL.
6. IF LOWEST LEVEL ELEVATION OF A BUILDING IS BELOW THE RIM ELEVATION OF UPSTREAM SANITARY SEWER MANHOLE, THEN TAP MUST INCLUDE BACKFLOW PREVENTION OR BE PUMPED TO GRAVITY.
7. GAS SERVICE SHALL MAINTAIN 18" OF VERTICAL CLEARANCE WHEN CROSSING OTHER UTILITIES.

HAMILTON COUNTY ENGINEERS SPECIAL PROVISIONS/TRAFFIC NOTES:

ALL CONSTRUCTION MUST CONFORM TO: "DRIVEWAY REGULATIONS AND PAVEMENT AND/OR RIGHT-OF-WAY OPENING PROVISIONS FOR THE UNINCORPORATED AREA OF HAMILTON COUNTY AS ADOPTED BY THE BOARD OF HAMILTON COUNTY COMMISSIONERS" WITH SUPPLEMENTS OR CHANGES THERETO.

THE OWNER SHALL SAVE HARMLESS THE BOARD OF COUNTY COMMISSIONERS AND ALL ITS REPRESENTATION FROM ALL SUITS, ACTIONS, OR CLAIMS OF ANY CHARACTER BOUGHT ON ACCOUNT OF ANY INJURIES OR DAMAGES SUSTAINED BY ANY PERSON OR PERSONS OR PROPERTY IN CONSEQUENCE OF THIS CONSTRUCTION PROJECT.

ITEM 614 - MAINTAINING TRAFFIC

ALL PAVEMENT AND/OR RIGHT-OF-WAY OPENING MUST CONFORM TO THE CURRENT ADDITION OF THE STATE OF OHIO DEPARTMENT OF HIGHWAY CONSTRUCTION AND MATERIAL SPECIFICATIONS, WITH SUPPLEMENTS OR CHANGES THERETO. ALSO, THE OWNER ASSUMES ALL RESPONSIBILITIES AND LIABILITIES REGARDING STRICT ADHERENCE TO APPLICABLE SECTIONS FOR THE MAINTENANCE OF TRAFFIC AND PUBLIC SAFETY AS SET FORTH IN THE "OHIO MANUAL OF UNIFORM TRAFFIC CONTROL DEVICES FOR STREETS AND HIGHWAYS." ALL TRAFFIC CONTROL DEVICES MUST BE IN PLACE PRIOR TO STARTING CONSTRUCTION.

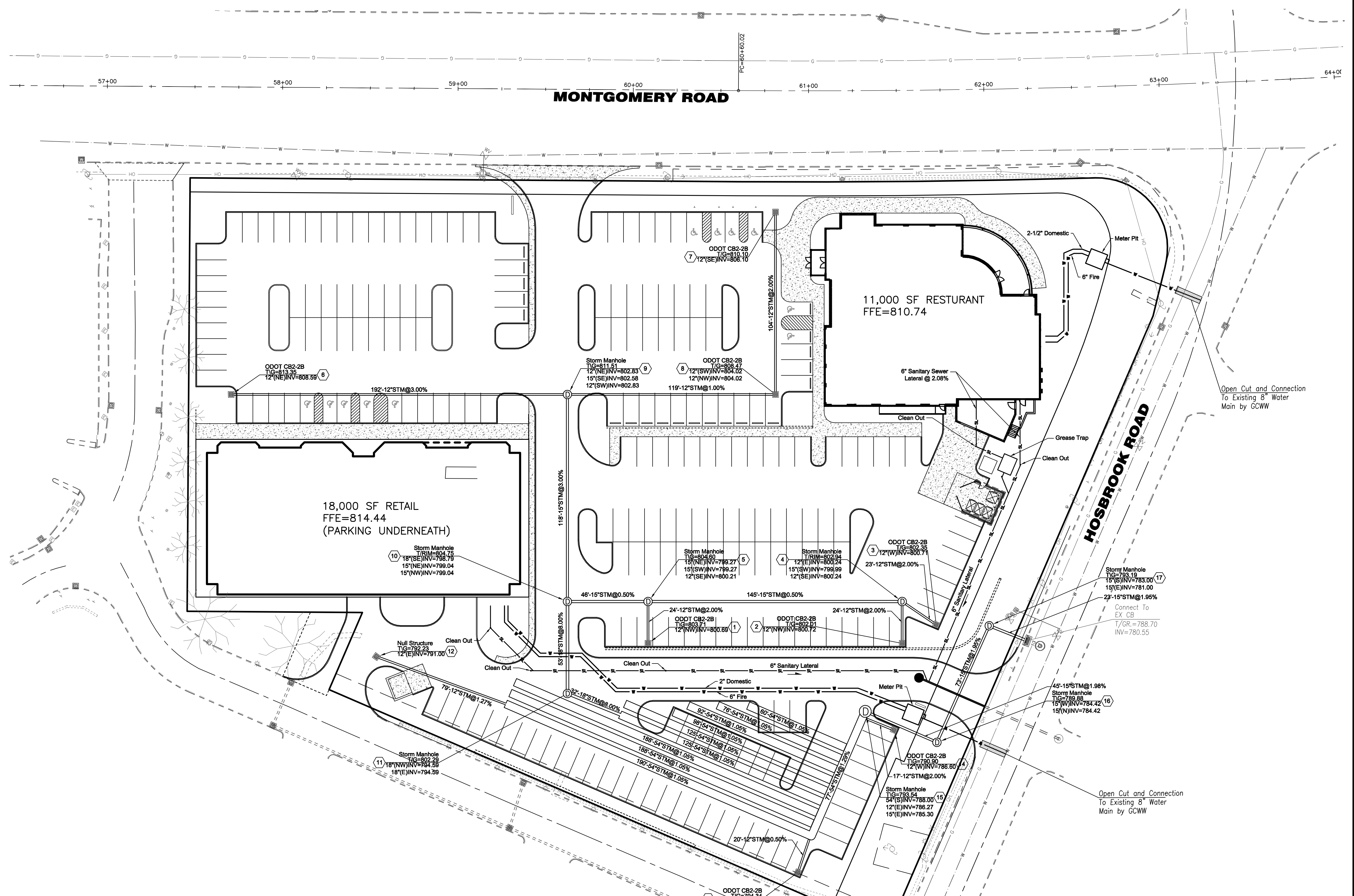

DUKE REALTY LIMITED PARTNERSHIP
 TRACT 1
 6.212 AC.
 O.R. 9358, PG. 6761

UNDERGROUND UTILITIES
 2 WORKING DAYS
BEFORE YOU DIG
 Call 1-800-362-2764
 OHIO UTILITY
 PROTECTION SERVICE
 NON MEMBERS
 MUST BE CALLED DIRECTLY

LOCATION OF ALL EXISTING UTILITIES TO BE DETERMINED IN THE FIELD PRIOR TO CONSTRUCTION.

Date	Drawn	Checked	Item	Revision Description

KENWOOD CITY PLACE
 8080 MONTGOMERY ROAD
 SYCAMORE TOWNSHIP
 HAMILTON COUNTY, OHIO

 www.bayerbecker.com
 6800 Tyersville Road, Suite A
 Mason, OH 45040 - 513.336.6600

Drawing: 07M028-002 CD
 Drawn by: EWM
 Checked by:
 Issue Date: 10-22-2012
 Sheet:

C4.0