

WELLINGTON GLEN CONDOMINIUM

ZONE DD
ZONE B

DANA MOTOR COMPANY, LLC
O.R. 8550, PG. 3547
PAR. 600-0060-0232-00

MONTGOMERY ROAD
N 11°35'00" E 35.08'
N 20°21'00" E 98.92'

ZONE B
ZONE EE

DANA MOTOR COMPANY, LLC
O.R. 7310, PG. 1492
PAR. 600-0060-0233-00

DANA MOTOR COMPANY, LLC
O.R. 7310, PG. 1492
PAR. 600-0060-0007-00

ZONE EE
ZONE E

MONTGOMERY DEVELOPMENT COMPANY
D.B. 4406, PG. 590
PAR. 600-0060-0012-00

ZONE B
ZONE E

DENNIS L. & C. KENNETH NEMENZ
O.R. 5464, PG. 71
PAR. 600-0060-0011-00

N 79°40'00" W 349.98'

DKK PARTNERS, LLC
O.R. 10728, PG. 2299
PAR. 600-0060-0010-00
1.002 AC.

S 79°40'00" E 313.00'

MARY R. HENSEL
O.R. 7788, PG. 252
PAR. 600-0060-0086-00

HOWARD A. & ELIZABETH K. TOFT
O.R. 7935, PG. 258
PAR. 600-0060-0085-00

HOWARD A. & ELIZABETH K. TOFT
D.B. 4211, PG. 1367
PAR. 600-0060-0009-00

ZONE B
ZONE 00

S 02°09'00" W 133.58'

ZONE 00
ZONE A

22
MARSHA ANN
WEAVER-BUTLER
PAR. 600-0060-0173-00

23
MICHAEL J. LOWRY
O.R. 8857, PG. 2825
PAR. 600-0060-0174-00

KENHILL SUBDIVISION
BLOCK B
P.B. 79, PG. 17-18

24
NICHOLAS M. & JULIANNE STRAUSS
D.B. 4239, PG. 1471
PAR. 600-0060-0175-00

25
PAUL J. &
JUDITH A. WOREMAN
O.R. 4322, PG. 2031
PAR. 600-0060-0176-00

26
KRISTIN H., TR. DUSTERBERG
O.R. 7639, PG. 2571
PAR. 600-0060-0177-00

LYNCRIS DRIVE

SCALE: 1"=30'
DATE: 09-18-14
DRAWN: JLL
DESIGNED: JLL
CHECKED:

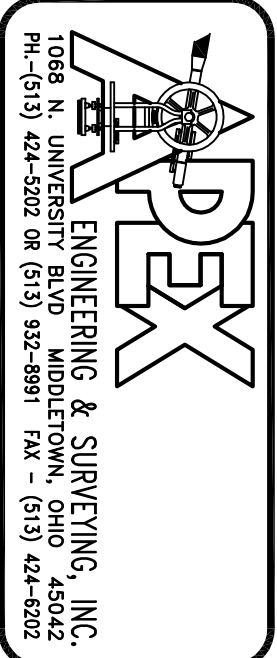

ZONING PLAT
SYCAMORE TWP. DENTAL FACILITY
8784 MONTGOMERY ROAD
SYCAMORE TOWNSHIP
HAMILTON COUNTY, OHIO

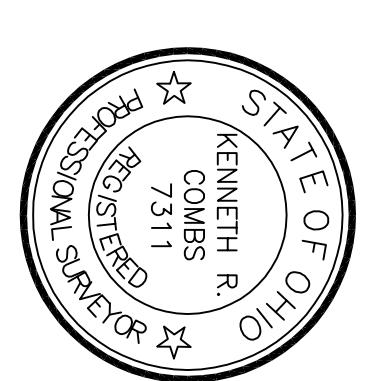

REVISIONS:
1
2
3
4
PROJECT: 141104
DRAWING: 141104B
SHEET
4 OF 4